

IBM PCjr Adapter Cable for the IBM Color Display Installation Instructions

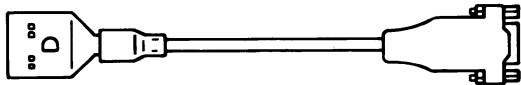
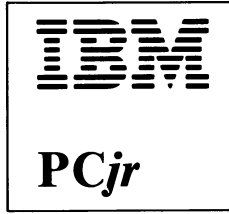

If your IBM PCjr has not been set up at this time, do so before installing this option.

This carton contains the following:

- IBM PCjr Adapter Cable for the IBM Color Display

If this item is missing or damaged, notify your place of purchase.

LIMITED WARRANTY

The International Business Machines Corporation warrants this IBM Personal Computer Product to be in good working order for a period of one year from the date of purchase from IBM or an Authorized IBM Personal Computer Dealer. Should this Product fail to be in good working order at any time during this one year warranty period, IBM will, at its option, repair or replace this Product at no additional charge except as set forth below. Repair parts and replacement Products will be furnished on an exchange basis and will be either reconditioned or new. All replaced parts and Products become the property of IBM. This limited warranty does not include service to repair damage to the Product resulting from accident, disaster, misuse, abuse, or non-IBM modification of the Product.

Limited Warranty service may be obtained by delivering the Product during the one year warranty period to an Authorized IBM Personal Computer Dealer, or any IBM Service/Exchange Center and providing proof of purchase date. If this Product is delivered by mail, you agree to insure the Product or assume the risk of loss or damage in transit, to prepay shipping charges to the warranty service location and to use the original shipping container or equivalent. Contact an Authorized IBM Personal Computer Dealer or write to IBM Personal Computer, Sales and Service, P.O. Box 1328-W, Boca Raton, Florida 33432, for further information.

ALL EXPRESS AND IMPLIED WARRANTIES FOR THIS PRODUCT INCLUDING THE WARRANTIES OF MERCHANTABILITY AND FITNESS FOR A PARTICULAR PURPOSE, ARE LIMITED IN DURATION TO A PERIOD OF ONE YEAR FROM THE DATE OF PURCHASE, AND NO WARRANTIES, WHETHER EXPRESS OR IMPLIED, WILL APPLY AFTER THIS PERIOD. SOME STATES DO NOT ALLOW LIMITATIONS ON HOW LONG AN IMPLIED WARRANTY LASTS, SO THE ABOVE LIMITATIONS MAY NOT APPLY TO YOU.

IF THIS PRODUCT IS NOT IN GOOD WORKING ORDER AS WARRANTED ABOVE, YOUR SOLE REMEDY SHALL BE REPAIR OR REPLACEMENT AS PROVIDED ABOVE. IN NO EVENT WILL IBM BE LIABLE TO YOU FOR ANY DAMAGES, INCLUDING ANY LOST PROFITS, LOST SAVINGS OR OTHER INCIDENTAL OR CONSEQUENTIAL DAMAGES ARISING OUT OF THE USE OF OR INABILITY TO USE SUCH PRODUCT, EVEN IF IBM OR AN AUTHORIZED IBM PERSONAL COMPUTER DEALER HAS BEEN ADVISED OF THE POSSIBILITY OF SUCH DAMAGES, OR FOR ANY CLAIM BY ANY OTHER PARTY.

SOME STATES DO NOT ALLOW THE EXCLUSION OR LIMITATION OF INCIDENTAL OR CONSEQUENTIAL DAMAGES FOR CONSUMER PRODUCTS, SO THE ABOVE LIMITATIONS OR EXCLUSIONS MAY NOT APPLY TO YOU.

THIS WARRANTY GIVES YOU SPECIFIC LEGAL RIGHTS, AND YOU MAY ALSO HAVE OTHER RIGHTS WHICH MAY VARY FROM STATE TO STATE.

FOR WARRANTY SERVICE OR ASSISTANCE IT IS RECOMMENDED THAT THIS PRODUCT BE RETURNED TO THE AUTHORIZED IBM PERSONAL COMPUTER DEALER FROM WHOM IT WAS PURCHASED OR TO ANY IBM SERVICE/EXCHANGE CENTER.

Contents

Installation Requirements	2
Tools Required	2
Installation Instructions	3

Installation Requirements

Your IBM PCjr must be set up before you can install this option.

An IBM Color Display and a IBM PCjr are required to complete this installation.

Tools Required

- None

Installation Instructions

- 1 Turn the IBM Color Display power off.

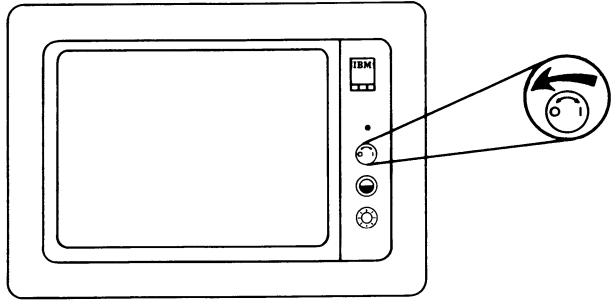

- 2 Turn your IBM PCjr power off.
- 3 Turn all external option power off (printer, TV, cassette, etc.).
- 4 Unplug the power cords for the IBM PCjr and all options from the wall outlets.
- 5 Turn your IBM PCjr so the rear is toward you.

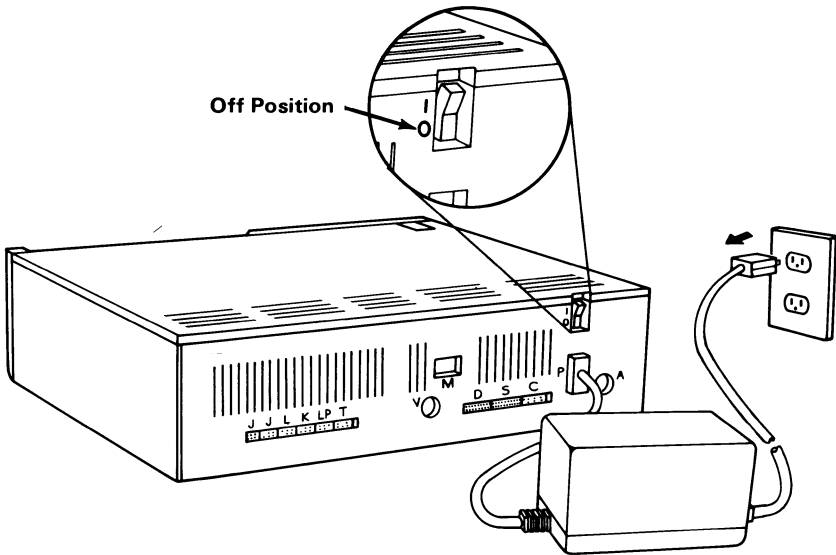

- 6 Find the connector on the rear of your IBM PCjr marked with a "D".
- 7 Find the end of your IBM PCjr Adapter Cable for the IBM Color Display marked "D".

Note: The letter "D" should be facing up when you plug the cable into the IBM PCjr.

- 8 Plug the end of the IBM PCjr Adapter Cable for the IBM Color Display marked "D" into the IBM PCjr connector marked with a "D".

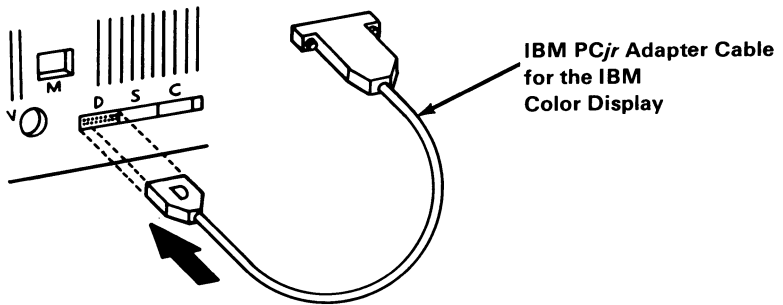

9 Find the IBM Color Display signal cable.

10 Plug the two cables together.

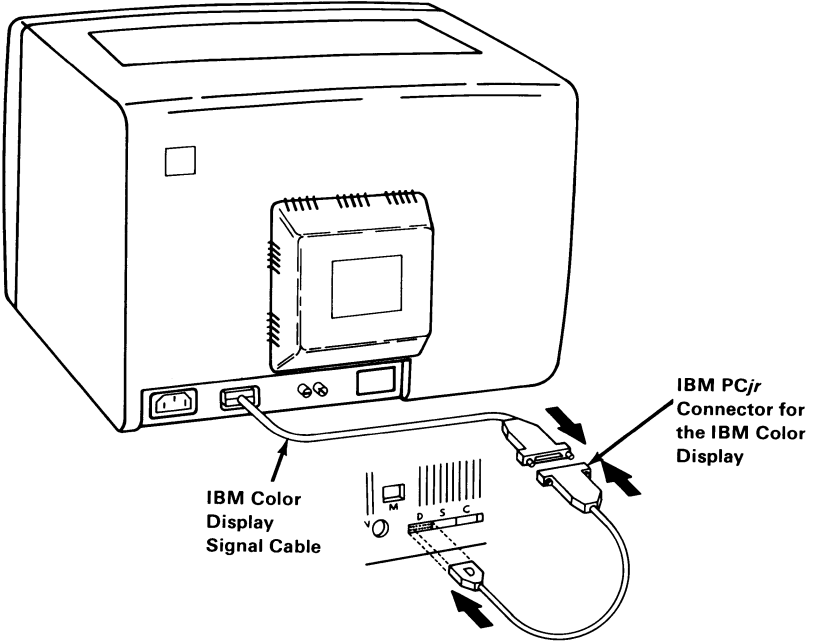

- 11** Plug the IBM Color Display power cord into the rear of the IBM Color Display.
- 12** Plug the other end of the IBM Color Display power cord into a wall outlet.

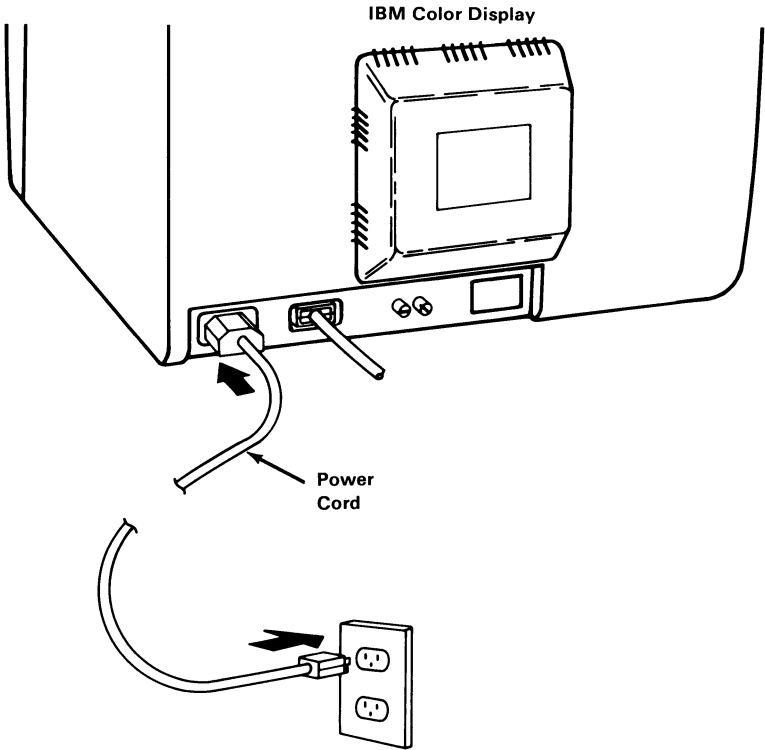

CAUTION:
Connect to a properly
grounded receptacle.

- 13** Plug the IBM PCjr and all option Power cords into wall outlets.

Important:

Insert these option instructions and the IBM Color Display option instructions into Section 5 of the *Guide to Operations* manual.

- 14** Go to Section 2 "Getting Started."

Note: You will find the operating instructions for your IBM Color Display in the option instructions for the IBM Color Display.

Notes:



Notes:



Notes:



Notes:



Notes:



Notes:

